

Installation Example

Pavement Class E 600 - F 900

Pour concrete in layers (lifts). Take suitable measures to prevent lateral and upward movement of channel units during pours.

Reinforcement Option

Reinforcement bar 10 mm, min. 2 m
long

Reinforcement bar 10 mm

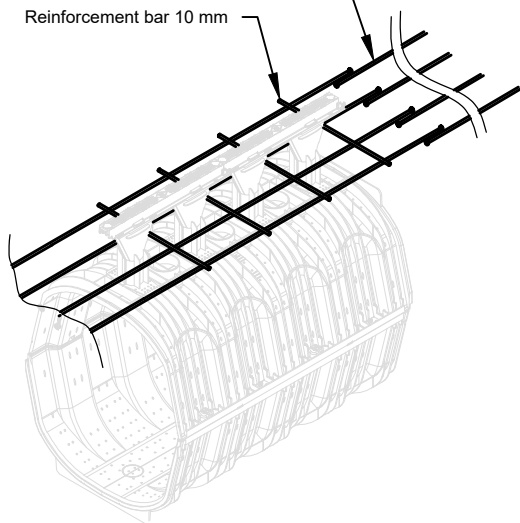

* y = Channel height plus camber

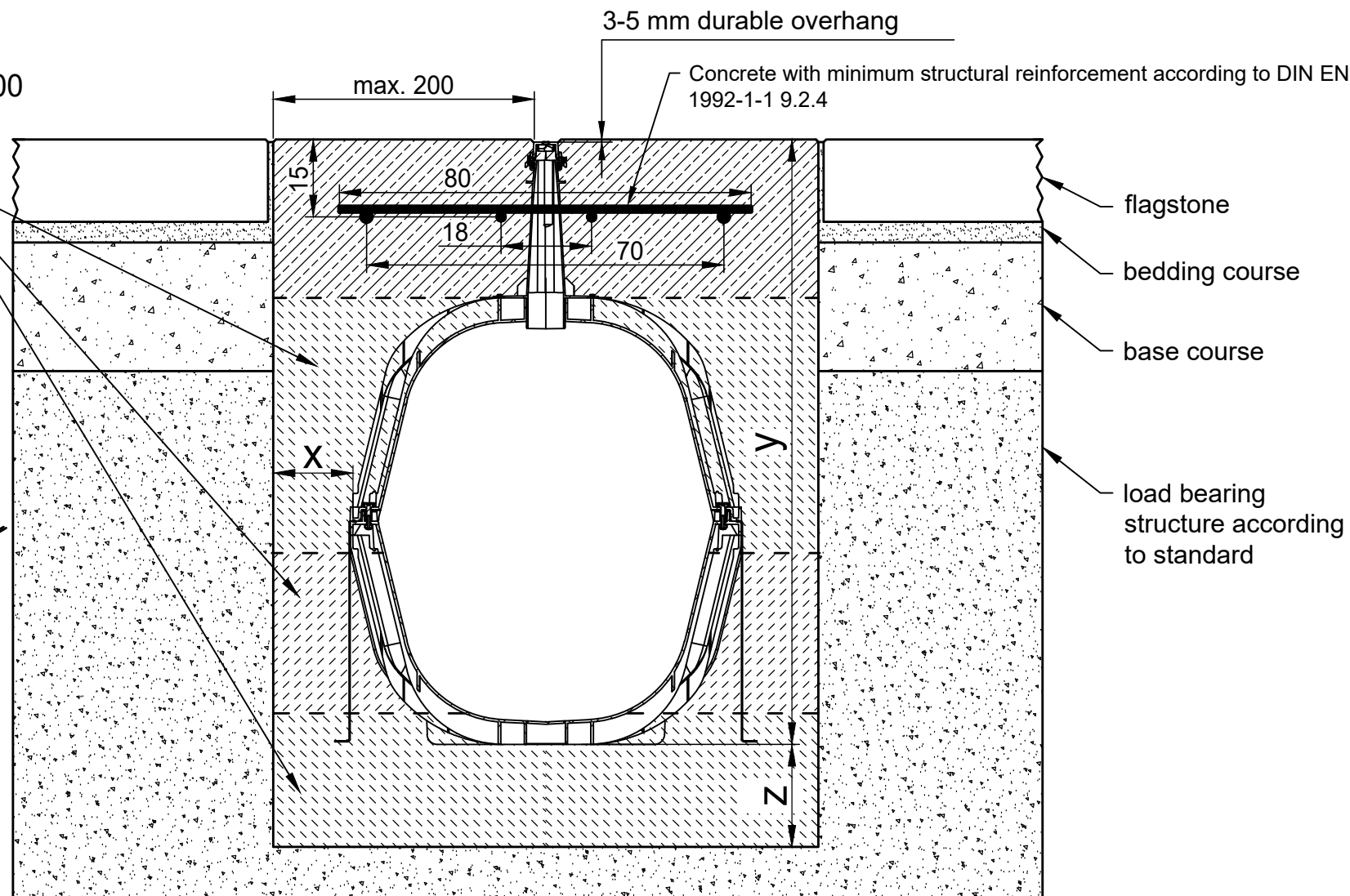

D	Category according to EN 1433 / DIN 19580		A 15	B 125	C 250	D 400**	E 600	F 900	Applying to following systems:	
	Foundation: width x / height y / thickness z (in cm)						20 / * / 20	20 / * / 20	RECYFIX HICAP F 10200, 10300	
	EN 206-1 / DIN 1045-2	quality of concrete stretcher					C35/45 XD3, XF4, XM2	C35/45 XD3, XF4, XM2		
	The named concrete quality is a minimum quality	without danger of frost on the lateral support					C25/30 X0	C25/30 X0		
		with danger of frost on the lateral support					C25/30 XF3	C25/30 XF3		
The installation examples / advise constantly are adapted to the technical conditions. With new editions older expenditures lose their validity. Before planning or installation please verify the current version at www.hauraton.com In building construction is a sealing layer below the channels necessary.					Date: 15.02.2024		Our general installation instructions apply.		Format DIN A4	 Unit 4, Frenchs Avenue LU6 1BH Dunstable / Bedfordshire United Kingdom Tel. +44 1582 501380 TS-UK@hauraton.com
The installation example represents a proven recommendation from HAURATON. The final responsibility for the execution lies with the planner in charge. Specific conditions of the project must be taken into account.									scale 1:12	
** Installation situations of drainage systems with high dynamic loads (e.g. airports, motorways and manoeuvring areas of buses, lorries and forklifts, etc.) are not sufficiently considered in DIN EN 1433. Please contact us for such applications to work out project-specific solutions.					0000098053_BRITISH.dwg		16	EBBw		
					RF-HICAP-F-10300 Einbaubeispiel Klasse E 600 in Pflaster					