

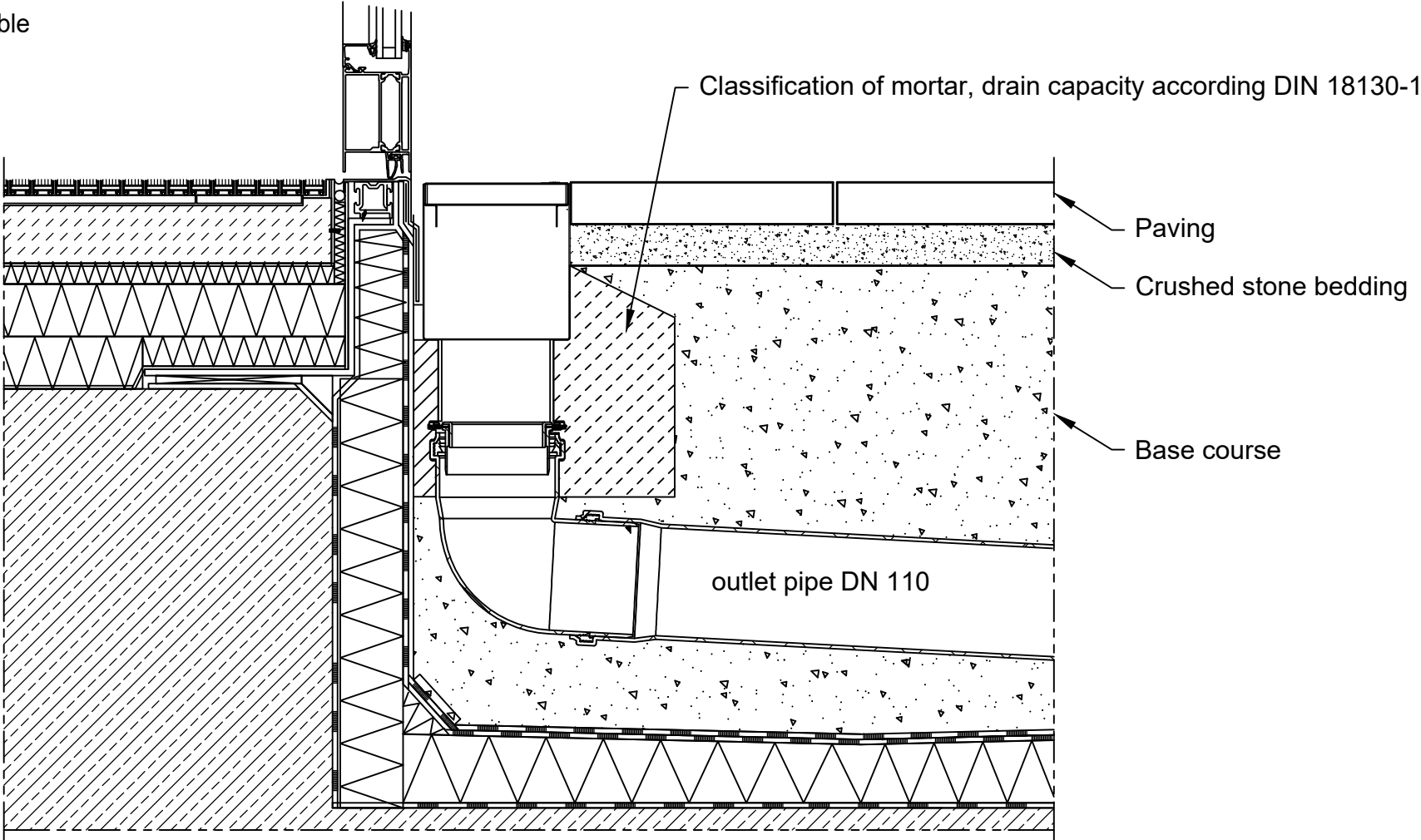

Drainage via channel connection, vertical, level entrance (0 cm)

Loading:
walkable, wheelchair accessible



Category according to EN 1433 / DIN 19580		A 15	B 125	C 250	D 400**	E 600**	F 900**	Applying to following systems:		
Foundation: width x / height y / thickness z (in cm)								DACHFIX STEEL 115, 135, 155, 205, 255		
EN 206-1 / DIN 1045-2 The named concrete quality is a minimum quality	quality of concrete stretcher									
	without danger of frost on the lateral support									
	with danger of frost on the lateral support									
<p>The installation examples / advise constantly are adapted to the technical conditions. With new editions older expenditures lose their validity. Before planning or installation please verify the current version at www.hauraton.com In building construction is a sealing layer below the channels necessary.</p> <p>The installation example represents a proven recommendation from HAURATON. The final responsibility for the execution lies with the planner in charge. Specific conditions of the project must be taken into account.</p> <p>** Installation situations of drainage systems with high dynamic loads (e.g. airports, motorways and manoeuvring areas of buses, lorries and forklifts, etc.) are not sufficiently considered in DIN EN 1433. Please contact us for such applications to work out project-specific solutions.</p>				Date: 03.06.2022		Our general installation instructions apply.		Format DIN	A4	 Unit 4, Frenchs Avenue LU6 1BH Dunstable / Bedfordshire United Kingdom Tel. +44 1582 501380 TS-UK@hauraton.com
								scale	1:6	
				0000088603_BRITISH.dwg						
DF-STEEL Einbaubeispiel Fassaden, Ein-/Ausgänge Entwässerung über Rinnenanschluss										